

8,11
 30
 4,12^s
 11^s
 3,27
 30

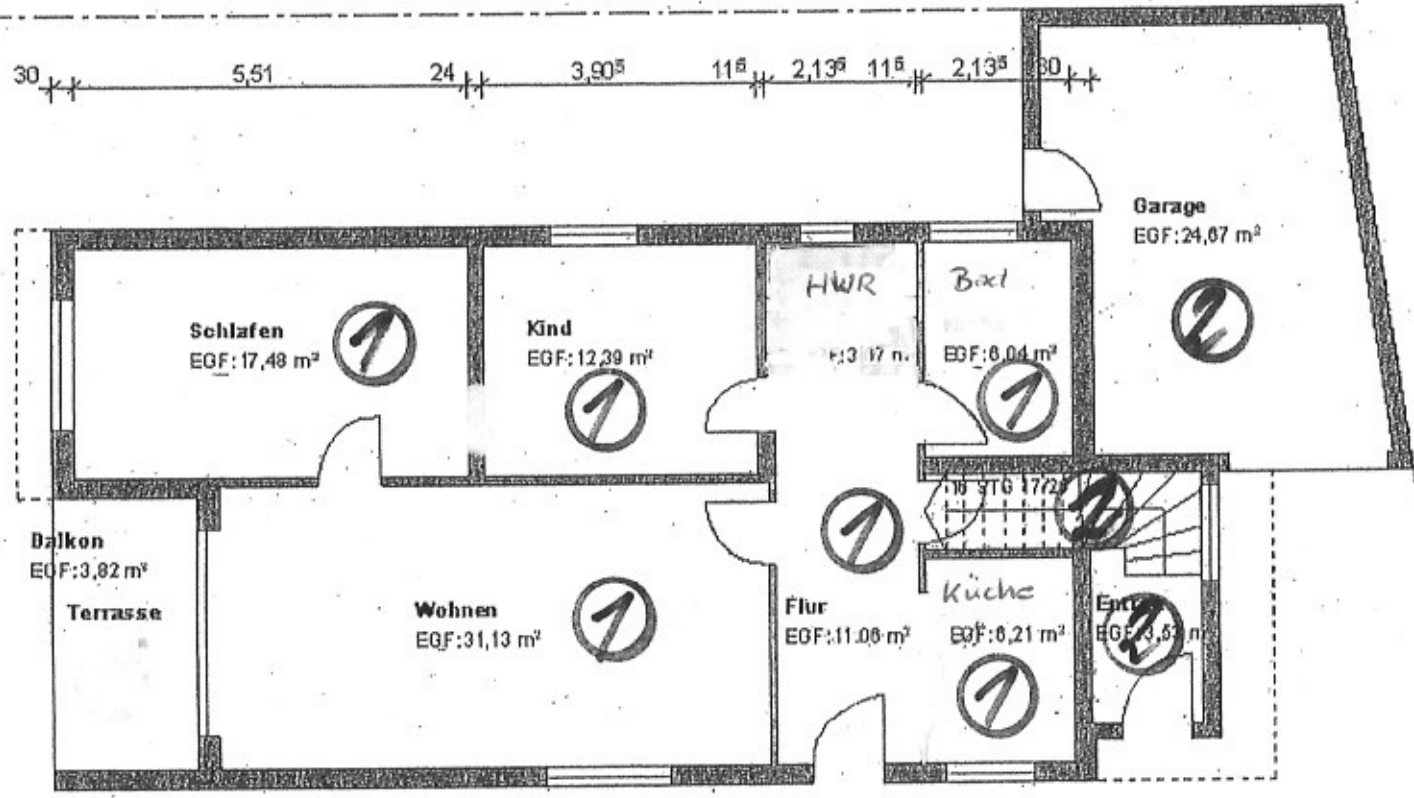

30 5,51 24 3,90^s 11^s 2,13^s 11^s 2,13^s 30

2,00 30 7,78 11^s 2,01 11^s 2,13^s 24 1,60 24
 14,75^s 1,78

30 5,52 11^s 1,77^s 1,30
 30 3,00 11^s 1,34 3,05^s 30
 62^s 24 3,65 24 3,35^s 2,76 24
 62^s 3,68 6,59^s

